



# SARZOTTI PARK

## MASTER PLAN

MAY 2017



## TABLE OF CONTENTS

BACKGROUND INFORMATION - PARK LOCATION MAP . . . . .	.3
COMMUNITY SURVEY AND RESULTS . . . . .	5
SARZOTTI PARK MASTER PLAN. . . . .	6
SARZOTTI PARK COST ESTIMATE. . . . .	14
COMMISSION MINUTES AND NOTES . . . . .	18
MASTER PLAN PROCESS . . . . .	APPENDIX

## BACKGROUND INFORMATION

Sarzotti Park is the City's largest active sports park and sits in the northern portion of the City. The park is home to the Ojai Recreation Department and the site of many of Ojai's recreation programs. The park includes the Boyd Center, the John G. Martin gymnasium and two Picnic Areas that are available to rent. Sarzotti Park is also home to two ballfields with year-round softball and soccer activities. Use of the fields is heavy and often accompanied by many spectators. In 2005, a new backstop building and restrooms were constructed for the ballfields. Drop in basketball, gymnastics and many other activities take place in the gymnasium. A fitness room with state-of-the-art equipment and free weights is also available at the Boyd Center. Baseball fields, horseshoe pits, a concession stand, a playground, and Oak shaded open space beckon people of all ages to enjoy the recreational opportunities at Sarzotti Park. The previous master plan dates from the mid-1990s. Taking public input on the plan helps ensure the park meets the anticipated and current needs of the community. The plan will include estimates for future improvements, but does not guarantee they will be constructed or address how they would be funded; it is simply a plan to ensure that if/when those projects come to fruition, they will all fit together in a cohesive manner.

## PARK LOCATION/VICINITY MAP

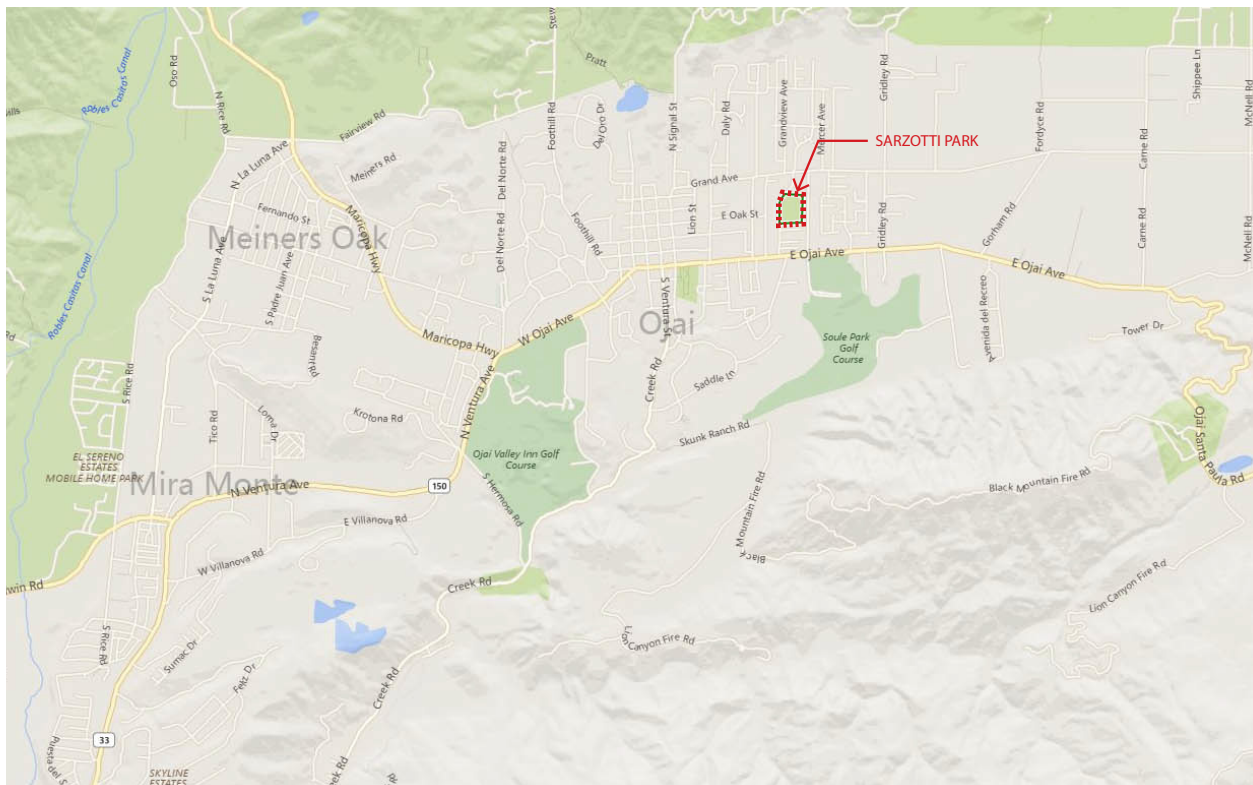



# SARZOTTI PARK AERIAL

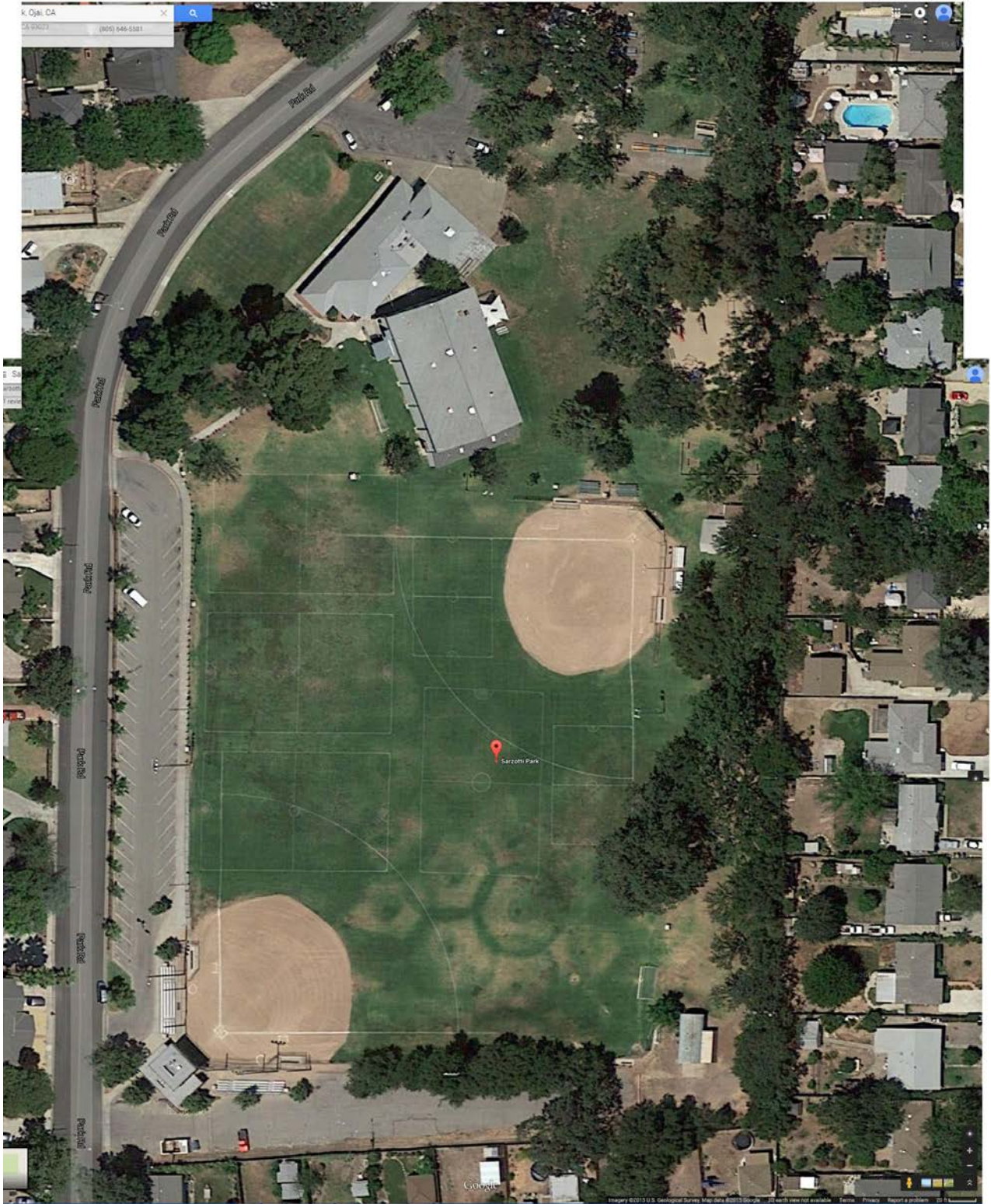

# SARZOTTI PARK SURVEY RESULTS

## Ojai Community Parks Survey Summary

### Tiny Tot Programs:

Participation Rates:

18% Participate "Occasionally"

7% Participate "Often"

Most Popular: Sports/Fitness/Recreation

Least Popular: Educational

### Youth Programs:

Participation Rates:

31% Participate "Occasionally"

27% Participate "Often"

Most Popular: Sports/Fitness/Recreation

Least Popular: Educational

### Teen Programs:

Participation Rates:

11% Participate "Occasionally"

13% Participate "Often"

Most Popular: Sports/Fitness/Recreation

Least Popular: Educational

### Adult Programs:

Participation Rates:

29% Participate "Occasionally"

19% Participate "Often"

Most Popular: Sports/Fitness/Recreation

Least Popular: Arts/Crafts/Music

### Suggestions for Additional Programs/Activities:

1. Swimming/Pool Activities
2. Disc Golf
3. Adult Educational Programs
4. Excursions
5. Umping/Sports Announcing Classes
6. Senior Programs
7. Cheerleading
8. Teen Awareness Programs
9. Special Needs Programs
10. Coed Soccer League
11. Table Tennis

12. Adult Softball
13. Wine Tastings
14. Martial Arts
15. Ballroom Dancing
16. Festivals
17. Kids Dance Classes
18. Music Practice/Jamming Sessions
19. Social Activities (Youth/Teens/Adults)
20. Painting Classes
21. Crossfit
22. Women's Sports Programs
23. Game Room
24. Mountain Biking
25. After School Arts
26. Homework Club
27. Swing Machine Skill for Teens
28. More Activity Downtown

### Outdoor Facilities:

Most Commonly Used (Often): Hiking Trail, Playgrounds, Biking Trails

Least Commonly Used (Often): Handball Court, Volleyball Court, Bike/BMX Park

### Suggestions for Additional Facilities:

1. Disc Golf
2. Lighted Outdoor Basketball Court
3. Community Pool
4. Water Playground
5. Shade (Sails, Structures, Trees)
6. Stationary Fitness Equipment
7. BMX/Scooter Park
8. Dog Wash Station
9. Full Facility Gym
10. Volleyball Court
11. Handball Court
12. Crossfit (Under Shade)
13. Updated Playgrounds
14. Tennis Courts
15. Bocce Ball Courts



## Sarzotti Park Master Plan

The Sarzotti Park Master Plan was designed and developed by the community of Ojai. The plan developed is a “plan” to guide the short and long term direction for the parks redevelopment.

One of the major needs of the existing park is for additional parking as well as defined pedestrian circulation routes in and around the park. The proposed parking lot on the northwest side of the park will help with the existing cumbersome parking that is currently in this area. Between the two western parking lots is a proposed drop off area which will serve the proposed community center addition and the central park amenities as well. With regards to circulation throughout the park, a series of walkways surrounding the park as well as to all of the proposed amenities has been provided. Along the perimeter walk are four exercise station areas. Each of these stations will include 3-4 pieces of outdoor exercise equipment. All walkway areas will be provided with low level “shoebox” style light posts at 15’ height.

Additional requested/high ranking amenities included in the Park Master Plan are a new restroom/ concessions and storage building located behind the northeast ballfield backstop. Adjacent to this facility is the new tot and child play areas as well as the adjoining water play area. The play areas include new play equipment, play matting and shade sail coverings. Also included along the eastern perimeter trail is a Teen Play area. This area provides a higher challenge level of play and also is intended to be an area that will encourage positive teen social interaction. Three additional group picnic areas have been included and will be provided with picnic tables and adjacent barbecues. Individual picnic areas are also provided along portions of the perimeter walk.

The existing multi-use turf area include up-grading the two ballfields and include adding a practice/T-Ball field on the northwest corner of the turf area.

A complete renovation of the irrigation system will be included to provide the latest in irrigation and water management in addition to Smart Controllers connected to real time weather conditions. The turf area soils will be analyzed and engineered based on estimated usage and the long term maintenance equipment, personnel and available down time. The new turf system will incorporate an aggressive, drought tolerant and quick recovery turf grass. A full maintenance program will be included with the new turf and irrigation design.

In the south east corner of the multi-use area two multi-use courts have been included. These lighted courts, which have low fencing surrounds can be used for basketball or Footsal.

A major addition to the park will be the new and expanded community center. Approximately 33,500 s.f. of new community indoor facilities will be provided. The new/expanded center will wrap around the existing gymnasium facility. New community rooms, offices, restrooms and serving kitchen will be provided within this facility. The existing Boyd Center, which is shown





the existing Boyd Center, which is shown as an outline, will need to be considered and decisions made regarding it's future.

All existing mature trees are to be preserved if at all possible and the Master Plan has been prepared to work with these existing amenities.

The long term prospects of Sarzotti Park serving the community for years to come looks very promising through the vision of the Ojai community.





PRELIMINARY MASTER PLAN  
**SARZOTTI PARK**  
 CITY OF OJAI

4444 Jackson Ave.  
 Riverside, CA 92506  
 (951) 949-9000  
 Fax: (951) 949-4310  
<http://www.commercialgroup.com>

**COMMUNITY CENTER PARKS**  
 DESIGN GROUP

DATE: 04/17/17  
 PROJECT #: 150638





VIEW LOOKING SOUTH



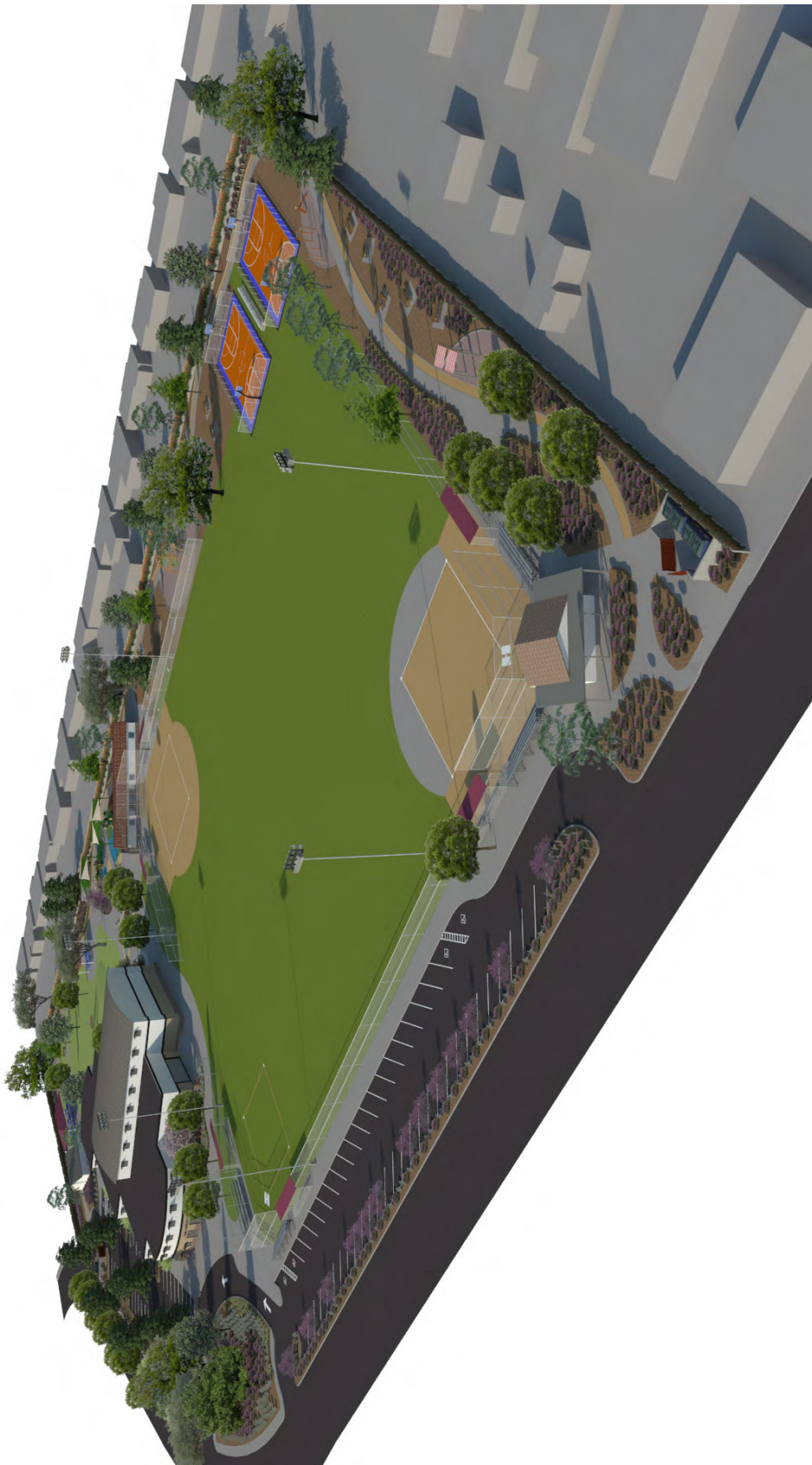

**VIEW LOOKING NORTH EAST**













**COMMUNITY WORKS DESIGN GROUP  
PRELIMINARY COST ESTIMATE**

**DATE:** 09/20/16

**ESTIMATE BY:** LYLE JANICEK

**PROJECT:** Sarzotti Park - Masterplan

**PROJECT #** 150638

<b>DESCRIPTION</b>	<b>QTY.</b>	<b>UNIT</b>	<b>UNIT COST</b>	<b>TOTAL COST</b>
MOBILIZATION / O.H. & PROFIT	267,571	L.S.	\$1.50	\$401,357
<b>DEMOLITION AND CLEARING</b>				
CLEAR AND GRUB	267,571	S.F.	\$0.25	\$66,893
RELOCATE MAINT HUT.	1	EACH	\$45,000.00	\$45,000
RELOCATE COMMUNITY CTR.	1	EACH	\$125,000.00	\$125,000
<b>GRADING/DRAINAGE/SEWER/WATER</b>				
SWPPP MEASURES	1	L.S.	\$20,000.00	\$20,000
PM-10 DUST CONTROL MEASURES	1	L.S.	\$10,000.00	\$10,000
EARTHWORK	242	C.Y.	\$18.00	\$4,350
FINE GRADING	267,571	S.F.	\$0.50	\$133,786
DRAINAGE IMPROVEMENTS	1	ALLOW	\$75,000.00	\$75,000
SEWER LINE	1	ALLOW	\$10,000.00	\$10,000
			<b>TOTAL:</b>	<b>\$253,136</b>
<b>CONSTRUCTION</b>				
<b>PLAY GROUND - TOT LOT</b>				
*PLAY EQUIPMENT - TOT LOT	1	ALLOW	\$75,000.00	\$75,000
CONCRETE CURB-12"	206	L.F.	\$50.00	\$10,300
PLAY AREA LIGHTS	2	EACH	\$5,000.00	\$10,000
FABRIC SHADE SAILS	1,512	S.F.	\$50.00	\$75,600
RUBBER MATTING	2,934	S.F.	\$15.00	\$44,010
3" CONCRETE BASE	2,934	S.F.	\$5.00	\$14,670
			<b>TOTAL:</b>	<b>\$229,580</b>
<b>CONSTRUCTION</b>				
<b>PLAY GROUND - CHILD PLAY</b>				
*PLAY EQUIPMENT - CHILD PLAY	1	ALLOW	\$75,000.00	\$75,000
CONCRETE CURB-12"	207	L.F.	\$50.00	\$10,350
PLAY AREA LIGHTS	2	EACH	\$5,000.00	\$10,000
FABRIC SHADE SAILS	1,512	S.F.	\$50.00	\$75,600
RUBBER MATTING	3,169	S.F.	\$15.00	\$47,535
3" CONCRETE BASE	3,169	S.F.	\$5.00	\$15,845
			<b>TOTAL:</b>	<b>\$234,330</b>
<b>CONSTRUCTION</b>				
<b>PLAY GROUND -TEEN PLAY</b>				
*PLAY EQUIPMENT - TEEN PLAY	1	ALLOW	\$50,000.00	\$50,000
CONCRETE CURB-12"	162	L.F.	\$50.00	\$8,100
PLAY AREA LIGHTS	2	EACH	\$5,000.00	\$10,000
			<b>TOTAL:</b>	<b>\$68,100</b>



DESCRIPTION	QTY.	UNIT	UNIT COST	TOTAL COST
<b>WATER PLAY</b>				
WATER PLAY EQUIPMENT	1	ALLOW	\$350,000.00	\$350,000
PLAY AREA LIGHTS	2	EACH	\$5,000.00	\$10,000
12" CATCH BASIN	4	EACH	\$1,000.00	\$4,000
4" CONCRETE PAVING	1,958	S.F.	\$5.00	\$9,790
			<b>TOTAL:</b>	<b>\$373,790</b>
<b>ZIP LINE</b>				
ZIP LINE AND ZIPLINE EQUIPMENT	1	ALLOW	\$15,000.00	\$15,000
			<b>TOTAL:</b>	<b>\$15,000</b>
<b>SITE FEATURES</b>				
PICNIC TABLE - 6'	14	EACH	\$1,250.00	\$17,500
TREE WELL D.G.	2	EACH	\$250.00	\$500
BENCH - W/BACK - METAL (6')	8	EACH	\$725.00	\$5,800
DRINKING FOUNTAIN SUMP	3	EACH	\$750.00	\$2,250
DRINKING FOUNTAIN	3	EACH	\$4,500.00	\$13,500
			<b>TOTAL:</b>	<b>\$39,550</b>
<b>EXERCISE STATION (INDIVIDUAL STATION)</b>				
DECOMPOSED GRANITE	9	CY	\$100.00	\$875
3" CONCRETE BASE	951	S.F.	\$5.00	\$4,755
CONCRETE CURB 12" x 18"	81	L.F.	\$50.00	\$4,050
*EXERCISE EQUIPMENT	1	ALLOW	\$10,000.00	\$10,000
			<b>TOTAL:</b>	<b>\$19,680</b>
<b>EXERCISE STATION (INDIVIDUAL STATION)</b>				
DECOMPOSED GRANITE	9	CY	\$100.00	\$875
3" CONCRETE BASE	951	S.F.	\$5.00	\$4,755
CONCRETE CURB 12" x 18"	81	L.F.	\$50.00	\$4,050
*EXERCISE EQUIPMENT	1	ALLOW	\$10,000.00	\$10,000
			<b>TOTAL:</b>	<b>\$19,680</b>
<b>EXERCISE STATION (INDIVIDUAL STATION)</b>				
DECOMPOSED GRANITE	9	CY	\$100.00	\$875
3" CONCRETE BASE	951	S.F.	\$5.00	\$4,755
CONCRETE CURB 12" x 18"	81	L.F.	\$50.00	\$4,050
*EXERCISE EQUIPMENT	1	ALLOW	\$10,000.00	\$10,000
			<b>TOTAL:</b>	<b>\$19,680</b>
<b>EXERCISE STATION (INDIVIDUAL STATION)</b>				
DECOMPOSED GRANITE	9	CY	\$100.00	\$875
3" CONCRETE BASE	951	S.F.	\$5.00	\$4,755
CONCRETE CURB 12" x 18"	81	L.F.	\$50.00	\$4,050
*EXERCISE EQUIPMENT	1	ALLOW	\$10,000.00	\$10,000
			<b>TOTAL:</b>	<b>\$19,680</b>
<b>BASKETBALL</b>				
POLE / 2 BACKBOARD / 2 HOOPS / 2 NETS	1	EACH	\$3,500.00	\$3,500
BASKETBALL LIGHTS	6	EACH	\$4,500.00	\$27,000
BASKETBALL SURFACE PAINT & STRIPING	3,849	S.F.	\$2.50	\$9,623



DESCRIPTION	QTY.	UNIT	UNIT COST	TOTAL COST
CONCRETE COURT - 6"	3,849	S.F.	\$10.00	\$38,490
			<b>TOTAL:</b>	<b>\$78,613</b>
<b>MULTI-SPORT FIELDS (FUTSAL AND BASKETBALL)</b>				
POLE / 2 BACKBOARD / 2 HOOPS / 2 NETS	2	EACH	\$3,500.00	\$7,000
BASKETBALL SURFACE PAINT & STRIPING	9,400	S.F.	\$2.50	\$23,500
FUTSALL/BASKETBALL LIGHTS	6	EACH	\$4,500.00	\$27,000
PERIMETER FENCING - 6 FT.	480	L.F.	\$38.00	\$18,240
CONCRETE COURT - 6"	9,400	S.F.	\$10.00	\$94,000
			<b>TOTAL:</b>	<b>\$169,740</b>
<b>HARDSCAPE</b>				
CONCRETE PAVING- 4"	59,362	S.F.	\$6.50	\$385,852
CONCRETE RAMP	1	L.S.	\$10,000.00	\$10,000
MULTI-COLORED PAVERS	1,319	S.F.	\$12.00	\$15,828
DECOMPOSED GRANITE	55.03	C.Y.	\$100.00	\$5,503
			<b>TOTAL:</b>	<b>\$417,183</b>
<b>LANDSCAPING</b>				
SOIL PREP / FINE GRADING	223,959	S.F.	\$1.00	\$223,959
WEED ABATEMENT	223,959	S.F.	\$0.05	\$11,198
90 DAY (MIN.) MAINTENANCE PERIOD	223,959	S.F.	\$0.50	\$111,980
LANDSCAPE AREAS	74,785	S.F.	\$1.50	\$112,178
TREES (24" BOX)	31	EACH	\$275.00	\$8,525
TREES (36" BOX)	8	EACH	\$750.00	\$6,000
TREES (48" BOX)	2	EACH	\$1,500.00	\$3,000
TURF SOD W/PRZ. DRAIN	128,718	S.F.	\$7.50	\$965,385
TURF SOD	20,456	S.F.	\$1.50	\$30,684
WOOD MULCH-3"	679	C.Y.	\$50.00	\$33,950
BOULDERS (2-3' DIA.)	13	EACH	\$550.00	\$7,150
			<b>TOTAL:</b>	<b>\$1,514,008</b>
<b>IRRIGATION</b>				
AUTOMATIC IRRIGATION SYSTEM				
ROTOR AREAS	139,684	S.F.	\$0.80	\$111,747
HARDLINE DRIP AREAS	73,332	S.F.	\$1.20	\$87,998
CONTROLLER	2	EACH	\$15,000.00	\$30,000
FLOW METER	1	L.S.	\$650.00	\$650
MASTER VALVE	1	L.S.	\$1,500.00	\$1,500
			<b>TOTAL:</b>	<b>\$231,895</b>
<b>ARCHITECTURE</b>				
COMMUNITY CENTER BUILDING	33,000	S.F.	\$350.00	\$11,550,000
RESTROOM / CONCESSION / STORAGE	3031	S.F.	\$300.00	\$909,300
			<b>TOTAL:</b>	<b>\$12,459,300</b>
<b>LIGHTING / ELECTRICAL</b>				
SECURITY WALKWAY / LIGHTS	50	EACH	\$4,500.00	\$225,000
CONDUIT, CONDUCTOR & MISC. ITEMS	1	L.S.	\$150,000.00	\$150,000
			<b>TOTAL:</b>	<b>\$375,000</b>





DESCRIPTION	QTY.	UNIT	UNIT COST	TOTAL COST
PARKING IMPROVEMENTS				
ASPHALT PAVING (3" W/ 4" BASE) W/SEAL COAT	21,891	S.F.	\$4.00	\$87,563
SEAL COAT FOR EXISISTING LOT	17,722	S.F.	\$0.20	\$3,544
CONCRETE CURB - 6"	1,335	L.F.	\$18.00	\$24,030
STRIPING - SINGLE LINE STALLS	90	EACH	\$15.00	\$1,350
STRIPING (DISABLED) - EMBLEM & SIGN	7	EACH	\$250.00	\$1,750
			<b>TOTAL:</b>	\$118,237

***	SUBTOTAL			\$17,124,431
***	10.00% CONTINGENCY			\$1,712,443
***	GRAND TOTAL			\$18,836,874

**\*Site specific equipment, obtain a quote from the manufacturer**

Cost Estimates provided above have been developed from current (2016) projected costs of construction. Annual construction costs should be adjusted upward approximately 5% per year.



## **COMMISSION MEETING MINUTES AND NOTES:**

**08-06-2015**

**REPORT ON SARZOTTI PARK MASTER PLAN**

**RECOMMENDATION: RECEIVE A REPORT ON MASTER PLAN PROCESS FOR SARZOTTI PARK, AND PROVIDE COMMENTS AND INPUT TO STAFF AND THE AD-HOC COMMITTEE.**

**09-03-2015**

**REPORT ON SARZOTTI PARK MASTER PLAN COMMUNITY OUTREACH MEETING**

**RECOMMENDATION: RECEIVE A REPORT ON THE MASTER PLAN UPDATE FOR SARZOTTI PARK, INCLUDING THE SURVEY AND COMMUNITY MEETING RESULTS, AND PROVIDE COMMENTS AND INPUT TO STAFF AND THE ADHOC COMMITTEE.**

**10-01-2015**

**REPORT ON SARZOTTI PARK MASTER PLAN**

**RECOMMENDATION: RECEIVE A REPORT ON THE MASTER PLAN UPDATE FOR SARZOTTI PARK AND PROVIDE FEEDBACK TO STAFF ON THE PRESENTATION SCHEDULED FOR THE NOVEMBER MEETING.**

**11-05-2015**

**A. SARZOTTI PARK MASTER PLAN**

**PUBLIC WORKS DIRECTOR/CITY ENGINEER GREG GRANT GAVE AN UPDATE ON PLANS FOR THE PICNIC SHELTER PROJECT AT SARZOTTI PARK. THE COMMISSION PROVIDED FEEDBACK ON THE PLANS.**

**MOTION:**

**IT WAS MOVED BY VICE CHAIR INTNER, SECONDED BY COMMISSIONER FIRESTONE, TO RECOMMEND ONE LARGE PICNIC SHELTER AREA, AND TWO SMALLER PICNIC SHELTERS, NEAR THE PARK PERIMETER; OR IF POSSIBLE, TO CONSIDER ONE SHELTER OR OTHER DESIGNS FOR THE LOCATION. THE MOTION PASSED WITHOUT OPPOSITION. (ABSENT: RODDICK)**

**12-03-2015**

**REPORT ON SARZOTTI PARK MASTER PLAN**

**PUBLIC WORKS DIRECTOR/CITY ENGINEER GREG GRANT PRESENTED THE REPORT.**

**THE COMMISSION DISCUSSED THE PROPOSED MASTER PLAN AND CONFIRMED THE DATE FOR THE SECOND PUBLIC OUTREACH MEETING TO BE HELD EITHER MONDAY, JANUARY 25 OR WEDNESDAY, JANUARY 27 AT 6:30P.M., AT OJAI CITY HALL.**

**1-07-2016**

**PUBLIC WORKS DIRECTOR/CITY ENGINEER GREG GRANT PRESENTED THE REPORT.**

**THE COMMISSION DISCUSSED THE MASTER PLAN AND PREFERRED THE FOLLOWING:**

**BRONZE METAL ROOF**

**BROWN COLUMNS**

**LOCATION 2A - CREATE SPACE FOR ACCESS ROAD**

**PREFER 30' x 50' ON THE STRUCTURE**

**ADDITIONAL 10 FEET OF CONCRETE PAST PAD**

**BARBECUE IN THE SOUTHEAST CORNER**

**APPROVE ART OF CONCEPT**



CHAIR DUTTER ASKED HOW RESERVATIONS ARE ENFORCED. STAFF SAID A COPY OF THE RESERVATION IS GIVEN TO THE PERSON OR PERSONS THAT RENT THE SPACE AND THEY TELL THE PEOPLE TO LEAVE. THERE IS AN EMERGENCY PHONE NUMBER AVAILABLE. COMMISSIONER RODDICK SUGGESTED PLACING RESERVED SIGNS IN THE AREA.

AS DISCUSSED AT THE RECENT NOVEMBER 5 AND DECEMBER 3, 2015 PARKS AND RECREATION COMMISSION (PRC) MEETINGS, THE RENOVATION OF THE PICNIC AND BBQ AREAS AT SARZOTTI PARK FUNDING GRANT REQUIRES THE PROJECT BEGIN CONSTRUCTION IN THE SPRING. THE INITIAL PROJECT WAS TO PLACE SHELTERS OVER THE EXISTING PICNIC AREAS, REPLACE THE DETERIORATED ASPHALT IN THOSE AREAS WITH CONCRETE, AND PROVIDE ADA ACCESS TO EACH AREA. BASED ON PRC AND THE MASTER PLAN CONSULTANT INPUT, THE PROJECT WAS REVISED TO PROVIDE ONE LARGER PICNIC AREA SHELTER, AND TWO SMALLER SHELTERS.

STAFF SPRAY PAINTED THE PROPOSED LAYOUT OF THE THREE SHELTERS ON THE GROUND AT SARZOTTI PARK (WHITE EDGE AND ORANGE CORNERS) FOR CONSIDERATION BY COMMISSIONERS AFTER THE DECEMBER 3 PRC MEETING. A PRC COMMISSIONER SUGGESTED AN OPTION FOR THE PRIMARY SHELTER BE CONSIDERED WHICH WOULD MOVE THE SHELTER WEST TOWARD THE RESTROOM AND CLOSER TO THE PERIMETER MAINTENANCE ROAD, RESULTING IN LESS INFRINGEMENT INTO THE OPEN AREA (REFERRED TO AS THE "MEADOW" ON THE PROPOSED DRAFT MASTER PLAN UNDERWAY)- THIS IS SHOWN AS "OPTION 1B" ON THE ATTACHED PLAN. OPTION 1A IS THE ORIGINAL ORIENTATION. BOTH ARE SPRAY PAINTED ON THE GROUND AT THE SITE. THE LARGER TREES ARE SHOWN ON THE PLAN, AND A FEW SMALLER TREES ( 6 TO 10 INCH DIAMETER) IMPACTED BY SHELTER 1 OPTIONS ARE SHOWN AS TRIANGLE SYMBOLS. THE INITIAL PROS AND CONS OF SHELTER # 1 OPTIONS ARE:

**PROS:** IT OPENS THE MEADOW/FIELD AREA QUITE A BIT AND LEAVES MORE OPEN SPACE FOR OTHER/FUTURE USES.

**CONS:** IT PUTS THE SHELTER IN TIGHTER AGAINST THE FENCE/BORDER AND MAY FEEL LESS OPEN TO THAT SIDE FOR PEOPLE USING/INSIDE THE SHELTER. THE SHELTER MAY BE REDUCED FROM 30' X 60' TO ROUGHLY 30' X 50' (10' SHORTER) TO AVOID A SMALL OAK TREE ON THE SOUTH SIDE, OR WE MAY REMOVE THE TREE.

**NOTE:** IN A PREVIOUS DISCUSSION IT WAS MENTIONED OPTION 1B IS CLOSER TO THE RESTROOM, IT IS ONLY MINIMALLY CLOSER AS SHOWN ON THE PLAN.

SHELTER #2 WAS REPOSITIONED SLIGHTLY TO AVOID EXISTING TREES AND LIGHT POLES. SHELTER #3 WAS MOVED AWAY FROM THE EXISTING PERIMETER ROAD AND TO AVOID EXISTING TREES AND LIGHT POLES.

NOTICES WERE PROVIDED TO ALL PROPERTIES BORDERING SARZOTTI PARK OF THE JANUARY 7, 2016 PRC MEETING AND THIS AGENDA ITEM.

01-25-2016

PUBLIC COMMENTS – NONE.



**SARZOTTI PARK MASTER PLAN UPDATE PUBLIC WORKSHOP**

**INPUT FROM THE COMMUNITY**

**BUILD NICE FENCE IN THE BACK AREA OF THE PARK**

**LONG TERM FINANCING**

**AREA FOR ROLLER HOCKEY**

**SITE LINE FROM PICNIC AREA TO PLAYGROUNDS**

**OUTDOOR COVER FOR "CROSS FIT" AREA**

**FAMILY GARDEN AREA**

**WATER RECLAMATION**

**LIGHTING OF BALL FIELDS SO DOESN'T DISRUPT NEIGHBORS**

**WILL EXISTING FIELDS BE USED DURING ANY CONSTRUCTION OR WILL THERE BE SOMEWHERE FOR ACTIVITIES**

**LONG TERM LIABILITIES AND FINANCING**

**MAINTENANCE COSTS**

**DOG PARK**

**DOG OFF LEASH CONCERNS**

**FUTSOL BALL (?) COURT IN BACK CORNER**

**CLUMPING GRASSES A CONCERN**

**CONSIDER SYNTHETIC GRASS IN PLAY/ACTIVITY CENTER**

**FUND RAISING NEEDS TO HAPPEN**

**NOISE CONCERNS**

**BUFFER OF GREENERY BETWEEN PARK AND PROPERTIES**

**ELECTRIC CAR PARKING SPOTS AND HOOKUPS**

**MORE MONITORING OF UNSAVORY ACTIVITIES**

**ZIP LINE FOR YOUTH**

**GRASS WITH BUMPS AND HILLS FOR KIDS TO PLAY**

**SAND VOLLEY BALL**

**KEEP TOT AREA FENCED**

**ONE CONCESSION AREA**

**BUILD BASKETBALL COURTS**

**STORAGE**

**LOW LEVEL LIGHTING THROUGHOUT THE PARK**

**DON'T CREATE AREAS WHERE YOUTH WILL CONGREGATE WITHOUT BEING MONITORED**

**PRESERVE HISTORICAL FEATURES**

**SOFTER USE AREA**

**NO WATER FEATURES IN DROUGHT SITUATION**

**CONCERN WITH OVERCROWDING IN PARK**

**CONCERN WITH UNSAVORY ACTIVITIES HAPPENING AND NOTHING BEING DONE NOW**

**FRISBEE PLAY AREA**

**COMMISSION COMMENTS**

**NEXT STEPS ARE TO FIGURE OUT BUDGET**

**REMOVE SAND VOLLEY BALL COURT**

**EXPAND FIELD AREA**

**MOVE WATER PLAY**

**EXPAND TOT AREA**

**INSTALL A TURF HILL**

**CONCESSION STAND/AREA**

**ZIP LINE, CLOSER TO PLAY AREA**

**EAST SIDE ACTIVITIES**

**NO DEAD SPACES**

**RESEARCH EASEMENTS**

**TWO BASKET BALL COURTS**

**TALKED ABOUT CHANGING ORIENTATION OF BASEBALL FIELDS**





**02-04-2016**

**A. SARZOTTI PARK PICNIC SHELTERS COLOR SCHEME**

**PUBLIC WORKS DIRECTOR/CITY ENGINEER GREG GRANT PRESENTED THE PRODUCT AND DESIGN FEATURES FOR THE PICNIC SHELTERS.**

**B. THE COMMISSION DISCUSSED THE PATHWAY, TURF OPTIONS, BARBECUE AREAS, SIZE OF BARBECUES, FENCING, COLOR SCHEME AND HOW THE SHELTERS FIT INTO THE SARZOTTI PARK MASTER PLAN.**

**SARZOTTI PARK MASTER PLAN UPDATE  
RECOMMENDATION**

**MAKE A RECOMMENDATION TO THE CITY COUNCIL TO ADOPT THE UPDATE TO THE SARZOTTI PARK MASTER PLAN.**

**NOTE: MATERIALS FOR THIS ITEM WILL BE PROVIDED IN ADVANCE OF THE FEBRUARY 4 MEETING. THE CONSULTANT IS WORKING ON THE CHANGES BEING MADE AS A RESULT OF INPUT RECEIVED AT THE JANUARY 25 PUBLIC OUTREACH MEETING .**

**03-03-2016**

**SARZOTTI PARK MASTER PLAN UPDATE**

**THE COMMISSION DISCUSSED THE FOLLOWING:**

- **THE COMMISSION ASKED TO CHANGE SOME OF THE PARKING TO ANGLE PARKING**
- **IF CHANGED WITH THE CURRENT FACILITY WILL REDUCE THE NUMBER**
- **THE COMMISSION WANTED TO KNOW NET GAIN LOST WITH PLAN AS IS, BOYD CENTER WHERE IT IS AND NEW PLAN, AND TOTAL NUMBER**
- **PROVIDED PHOTOS SHOWING EXAMPLES OF EQUIPMENT FOR THE TEEN AREA**
- **FUTSAL BALL – SHOWED PHOTOS OF FUTSAL FIELDS**
- **PLACE FULL REGULATION SIZE BASKETBALL COURTS IN UPPER RIGHT CORNER**
- **COMBINE FUTSAL AND BASKETBALL COURTS INTO ONE**
- **PROVIDE A RENDERING/DRAWING WITH DIMENSIONS FOR THE BASKETBALL/FUTSAL COURTS (FENCE BETWEEN COURTS)?**
- **COMMUNITY GARDEN REMOVED**
- **BASE PATHS FOR THE PONY FIELD (THE NORTHWEST FIELD) REVISED TO SHOW DIRT PATHS**
- **THE TRAIL AND WALK PROVIDE A 15-FOOT ACCESS ROAD AROUND THE PERIMETER OF THE PARK**
- **AREA BY EXISTING GYMNASIUM (CURRENTLY DESIGNATED HITTING WALLS/BASKETBALL) USE FOR MULTI-USE ACTIVITIES**
- **PROVIDE COSTS FOR INDIVIDUAL PROJECTS (TEEN AREA, TOT AREA)**

**05-05-2016**

**SARZOTTI PARK MASTER PLAN UPDATE**

**MR. COTSIS STATED THAT THE COMMISSION HAD REQUESTED UPDATED PLANS WITH OVERLAYS SHOWING THE CHANGE IN THE PARKING LOT CONFIGURATION, HOWEVER, TO DO THAT WOULD BE AT A COST OF APPROXIMATELY \$3,500 AS IT IS A CHANGE IN THE SCOPE OF WORK. THE PLANS DO SHOW THE LOCATION OF THE HITTING WALL AND CROSS-FIT AREA.**

**MR. COTSIS ALSO COMMENTED THAT THEY WERE SEVERAL MONTHS BEHIND THE TIME LINE WITH RESPECT TO THE MASTER PLAN WHICH STILL NEEDS TO GO BEFORE THE PLANNING COMMISSION, AND THE HISTORIC PRESERVATION COMMISSION BEFORE IT CAN BE PRESENTED TO CITY COUNCIL. HE STATED THAT IF THE COMMISSION WAS COMFORTABLE WITH THE PLAN THEN HE WAS REQUESTING A RECOMMENDATION TO MOVE IT FORWARD.**



THE COMMISSION FURTHER DISCUSSED REMOVING THE HITTING WALL FROM THE CURRENT RENDITION AND ADDING THE HITTING WALL ONLY AS A DESIRED AMENITY, AND OTHER OPTIONS OF PLACING A SMALLER WALL IN ANOTHER LOCATION. DIRECTION WAS GIVEN TO STAFF TO KEEP A SMALL REINFORCED WALL IN THE PLAN WHICH WOULD BE SURROUNDED BY GRASS (NO CONCRETE).

**MOTION:**

IT WAS MOVED BY COMMISSIONER FIRESTONE, SECONDED BY VICE CHAIR LINTNER, TO ACCEPT THE MASTER PLAN WITH THE WALL REVISION AS DISCUSSED. ON ROLL CALL THE VOTE WAS:  
AYES: DUTTER, GILBERT, FIRESTONE, FORD, LINTNER, WILSON  
NOES: NONE  
ABSENT: RODDICK  
ABSTAIN: NONE

**06-02-2016**

SARZOTTI MASTER PLAN: MR. COTSIS STATED THAT THE PLANNING COMMISSION WOULD BE REVIEWING THE SARZOTTI MASTER PLAN ON JULY 6, 2016.

**07-07-2016**

SARZOTTI MASTER PLAN: MR. COTSIS REPORTED THAT THE PLAN WAS PRESENTED TO THE PLANNING COMMISSION ON THE PRIOR EVENING. FEEDBACK FROM THE PLANNING COMMISSION WAS POSITIVE WITH RESPECT TO THE LAYOUT AND DESIGN THOUGH THEY EXPRESSED CONCERN ABOUT PLANS FOR THE BOYD CENTER. THE PLAN WILL NOW BE BROUGHT TO THE HISTORIC PRESERVATION COMMISSION ON JULY 14 AT 6:00P.M.

**02-06-2017**

PARKS AND RECREATION COMMISSION MEETING  
APPROVED MASTER PLAN WITH INTENTIONS TO MOVE TO CITY COUNCIL FOR FINAL APPROVAL

**03-28-2017**

OJAI CITY COUNCIL MEETING



## MASTER PLAN PROCESSES

Community Meetings, Community Survey, Commission Meetings and Workshops were held from July 2015 thru August of 2016 to gain community input and support for creating a strategic direction for delivery of public recreation facilities and amenities that will focus on meeting the needs of the changing demographics. The Master plans will also provide a basis for submittal of grant applications and will ensure sustainable operations of the City's parks over the next 20 years or more.

Conducting a Community Survey regarding recreation programs and facilities provides the opportunity to gain knowledge about the community in addition to the desires for amenities and programs provided by the parks department. The complete results of the survey are provided as an Appendix to this report. In regards to facilities, results from the survey indicated the following rated highest and desired amenities in the City parks.

### Sarzotti Park

- Aquatics facilities and Water Play both rated high.
- Playgrounds
- Picnic facilities
- Bike trails and hiking trails
- BMX trails
- Volleyball
- Disc Golf
- Basketball Courts

From the Community input meetings and the Park and Recreation Community meetings additional input was incorporated into the final Master Plan. Including:

- Futsal Courts
- Zip Line
- Expanded Community Center
- Tee Ball field
- Additional Restroom/Concessions facilities
- Covered picnic areas

## MASTER PLAN DEVELOPMENT

Sarzotti Park was developed following community input. From the community meetings, community survey, the requests of city staff, the master plans developed in accordance with the site analysis and community input.



# Ojai Community Parks Survey

The purpose of this survey is to determine the facilities and activities community residents would like to see within Sarzotti Park (510 Park Road), and to also determine the current usage and future need of recreational facilities and activities in the Ojai area.

**Community Outreach Meeting: Saturday, August 29, 2015** – Boyd Center at Sarzotti Park – 510 Park Road, Ojai

Survey Monkey link: <http://www.surveymonkey.com/r/OjaiParks>

## PARKS & RECREATION DEPARTMENT ACTIVITIES & PROGRAMS

1. a. The following is a list of **activities/programs** available through the Parks and Recreation Department. Please indicate how often you or members of your family have participated in these activities/programs, and for each activity/program, please indicate whether or not there is a need for more.

Recreational Activity/Program	How often have you/family members participated in these recreational activities/programs?			Do you/family members see a need for more of these activities/programs?	
	Never	Occasionally	Often	Yes	No
<b>Tiny tot programs</b>					
Educational.....	<input type="radio"/>	<input type="radio"/>	<input type="radio"/>	<input type="radio"/>	<input type="radio"/>
Sports/fitness/recreation.....	<input type="radio"/>	<input type="radio"/>	<input type="radio"/>	<input type="radio"/>	<input type="radio"/>
Arts/crafts/music.....	<input type="radio"/>	<input type="radio"/>	<input type="radio"/>	<input type="radio"/>	<input type="radio"/>
Other_____	<input type="radio"/>	<input type="radio"/>	<input type="radio"/>	<input type="radio"/>	<input type="radio"/>
<b>Youth programs</b>					
Educational.....	<input type="radio"/>	<input type="radio"/>	<input type="radio"/>	<input type="radio"/>	<input type="radio"/>
Sports/fitness/recreation.....	<input type="radio"/>	<input type="radio"/>	<input type="radio"/>	<input type="radio"/>	<input type="radio"/>
Arts/crafts/music.....	<input type="radio"/>	<input type="radio"/>	<input type="radio"/>	<input type="radio"/>	<input type="radio"/>
Camps.....	<input type="radio"/>	<input type="radio"/>	<input type="radio"/>	<input type="radio"/>	<input type="radio"/>
Other_____	<input type="radio"/>	<input type="radio"/>	<input type="radio"/>	<input type="radio"/>	<input type="radio"/>
<b>Teen programs</b>					
Educational.....	<input type="radio"/>	<input type="radio"/>	<input type="radio"/>	<input type="radio"/>	<input type="radio"/>
Sports/fitness/recreation.....	<input type="radio"/>	<input type="radio"/>	<input type="radio"/>	<input type="radio"/>	<input type="radio"/>
Arts/crafts/music.....	<input type="radio"/>	<input type="radio"/>	<input type="radio"/>	<input type="radio"/>	<input type="radio"/>
Other_____	<input type="radio"/>	<input type="radio"/>	<input type="radio"/>	<input type="radio"/>	<input type="radio"/>
<b>Adult programs</b>					
Sports/fitness/recreation.....	<input type="radio"/>	<input type="radio"/>	<input type="radio"/>	<input type="radio"/>	<input type="radio"/>
Adult sports league.....	<input type="radio"/>	<input type="radio"/>	<input type="radio"/>	<input type="radio"/>	<input type="radio"/>
Arts/crafts/music.....	<input type="radio"/>	<input type="radio"/>	<input type="radio"/>	<input type="radio"/>	<input type="radio"/>
Other_____	<input type="radio"/>	<input type="radio"/>	<input type="radio"/>	<input type="radio"/>	<input type="radio"/>

- b. What other 2 **activities/programs**, not listed above, would you like to see offered through the Parks and Recreation Dept.?

1. \_\_\_\_\_ 2. \_\_\_\_\_

2. **IF YOU HAVE SCHOOL-AGE CHILDREN IN YOUR HOUSEHOLD, PLEASE CONTINUE. IF NOT, PLEASE SKIP TO QUESTION 3.**

The next couple of questions are designed to determine the need for the Parks and Recreation Department to offer an after-school program.

- a. Do you currently have your child(ren) enrolled in an after-school program?

- No  
 Yes..... ***IF YES, please indicate the location and the ages of your children enrolled . . .***

Location of current after-school program: \_\_\_\_\_

Ages of children currently enrolled in an after-school program: \_\_\_\_\_

- b. Using a scale from 1 to 5 where 1 is equal to "Not At All Likely to Enroll" and 5 is equal to "Very Likely to Enroll," please indicate how likely you would be to enroll your child(ren) in an after-school program offered through the Parks and Recreation Department.

\_\_\_\_\_ 1 Not likely at all to enroll \_\_\_\_\_ 2 \_\_\_\_\_ 3 \_\_\_\_\_ 4 \_\_\_\_\_ 5 Very likely to enroll





**CURRENT RECREATIONAL FACILITIES & ACTIVITIES**

3. a. The following is a list of recreational facilities available or desired at Ojai neighborhood park sites. Please indicate how often you or members of your family use these facilities, and for each facility, please indicate whether or not there is a need to develop more at area park sites.

Outdoor Recreational Facility	How often do you/family members use these outdoor recreational facilities currently located at area park sites?			Do you/family members see a need to develop more of these facilities at area park sites?	
	Never	Occasionally	Often	Yes	No
Baseball field.....	<input type="radio"/>	<input type="radio"/>	<input type="radio"/>	<input type="radio"/>	<input type="radio"/>
Basketball court .....	<input type="radio"/>	<input type="radio"/>	<input type="radio"/>	<input type="radio"/>	<input type="radio"/>
Bike / BMX park.....	<input type="radio"/>	<input type="radio"/>	<input type="radio"/>	<input type="radio"/>	<input type="radio"/>
Biking trail .....	<input type="radio"/>	<input type="radio"/>	<input type="radio"/>	<input type="radio"/>	<input type="radio"/>
Disc/Frisbee golf .....	<input type="radio"/>	<input type="radio"/>	<input type="radio"/>	<input type="radio"/>	<input type="radio"/>
Dog park .....	<input type="radio"/>	<input type="radio"/>	<input type="radio"/>	<input type="radio"/>	<input type="radio"/>
Football field.....	<input type="radio"/>	<input type="radio"/>	<input type="radio"/>	<input type="radio"/>	<input type="radio"/>
Handball court.....	<input type="radio"/>	<input type="radio"/>	<input type="radio"/>	<input type="radio"/>	<input type="radio"/>
Hiking trail .....	<input type="radio"/>	<input type="radio"/>	<input type="radio"/>	<input type="radio"/>	<input type="radio"/>
Picnic facilities.....	<input type="radio"/>	<input type="radio"/>	<input type="radio"/>	<input type="radio"/>	<input type="radio"/>
Playground.....	<input type="radio"/>	<input type="radio"/>	<input type="radio"/>	<input type="radio"/>	<input type="radio"/>
Scooter park.....	<input type="radio"/>	<input type="radio"/>	<input type="radio"/>	<input type="radio"/>	<input type="radio"/>
Swimming pool.....	<input type="radio"/>	<input type="radio"/>	<input type="radio"/>	<input type="radio"/>	<input type="radio"/>
Skate park.....	<input type="radio"/>	<input type="radio"/>	<input type="radio"/>	<input type="radio"/>	<input type="radio"/>
Soccer field .....	<input type="radio"/>	<input type="radio"/>	<input type="radio"/>	<input type="radio"/>	<input type="radio"/>
Softball field .....	<input type="radio"/>	<input type="radio"/>	<input type="radio"/>	<input type="radio"/>	<input type="radio"/>
Tennis court .....	<input type="radio"/>	<input type="radio"/>	<input type="radio"/>	<input type="radio"/>	<input type="radio"/>
Volleyball court.....	<input type="radio"/>	<input type="radio"/>	<input type="radio"/>	<input type="radio"/>	<input type="radio"/>
Water playground.....	<input type="radio"/>	<input type="radio"/>	<input type="radio"/>	<input type="radio"/>	<input type="radio"/>

- b. What 2 recreational facilities not available at current Ojai neighborhood park sites would you like to see?  
 1. \_\_\_\_\_ 2. \_\_\_\_\_

**LEARNING ABOUT RECREATIONAL FACILITIES & ACTIVITIES**

4. Which of the following ways have you and others in your household learned about recreational facilities and activities in your area? . . . Mark all that apply.  
 Postcard mailed to household    Facebook/ Social Media    Ojai Recreation Guide    Website  
 Flyer distributed by school or other organization    Word of mouth    Newspaper    Other: \_\_\_\_\_

**RESIDENT PROFILE**

5. a. Your age group:  
 Under 15 years old    15 - 19 years old    20 - 29 years old    30 - 39 years old    40 - 49 years old    50 - 59 years old    60+ years old
- b. Your gender:  
 Male    Female
- c. Do you live within Ojai city limits?  
 Yes    No

6. a. Number of people living in your household: \_\_\_\_\_  
 b. Number of children (17 years or younger) living in your household: \_\_\_\_\_

**That's it! Thank you so very much!**

Please write additional comments and suggestions in the space below or attach an additional page.



# PORTIONS OF THE COMMUNITY PARK AND RECREATION QUESTIONNAIRE

Q1: How often have you/family members participated in Tiny Tot recreational activities/programs?

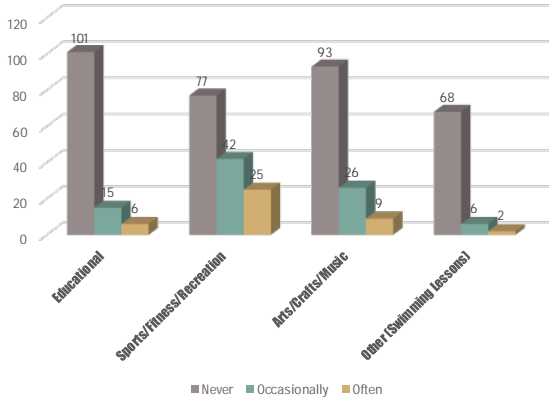

Q2: Do you/family members see a need for more Tiny Tot activities/programs?

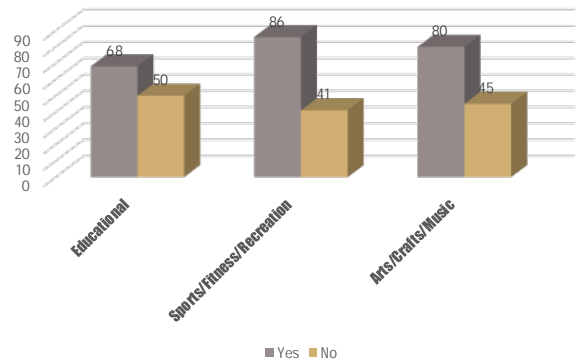

Q3: How often have you/family member participated in Youth recreational activities/programs?

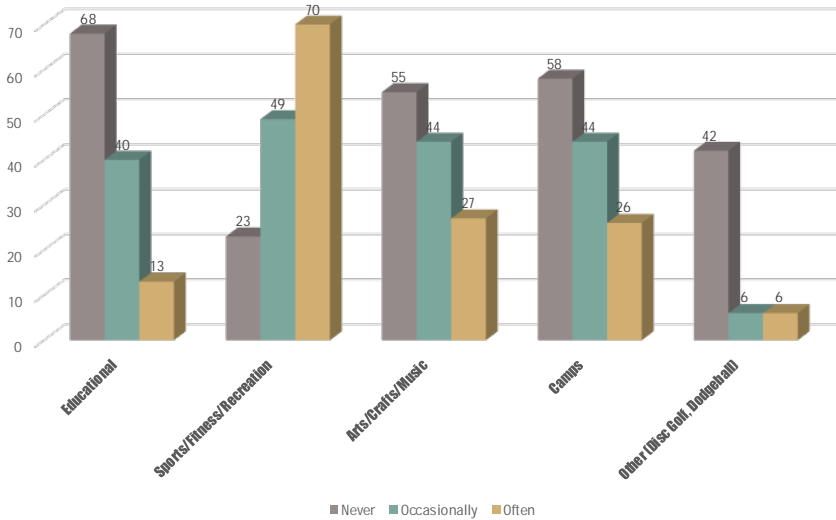

Q4: Do you/family members see a need for more Youth activities/programs?

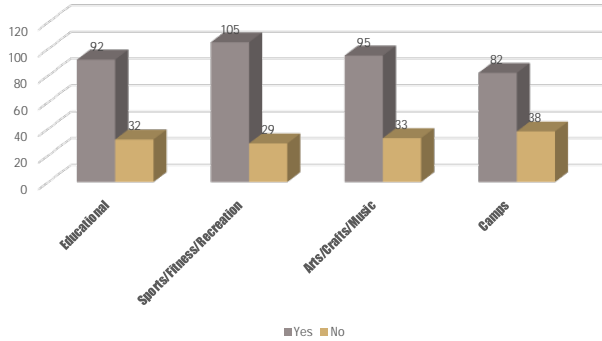

Q5: How often have you/family members participated in Teen recreational activities/programs?

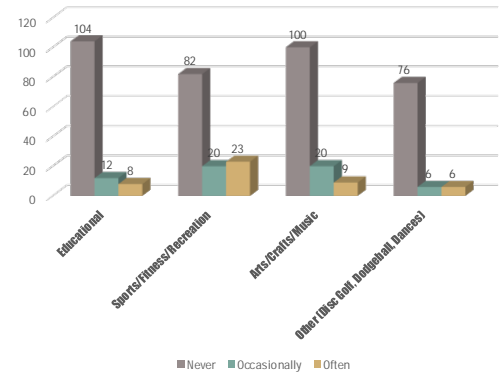

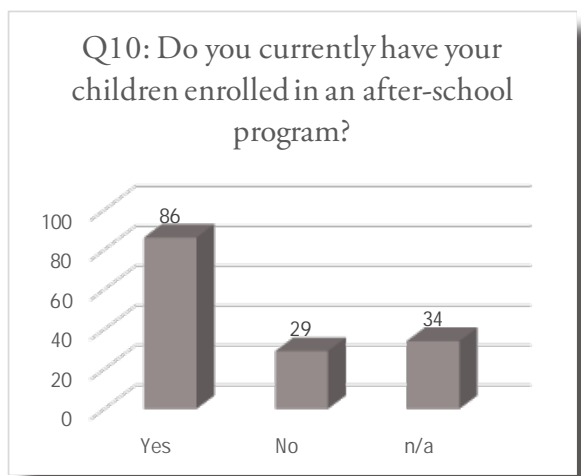
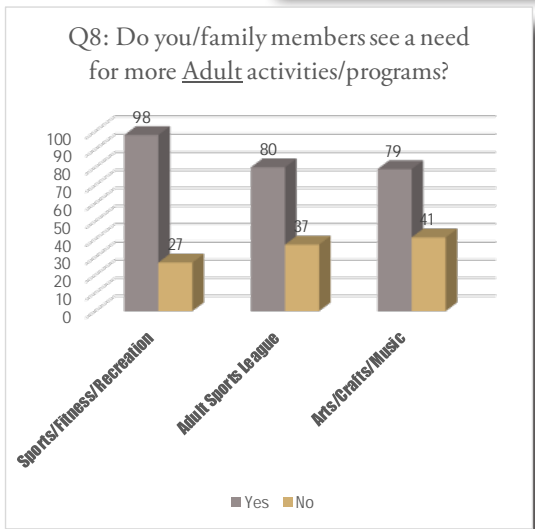
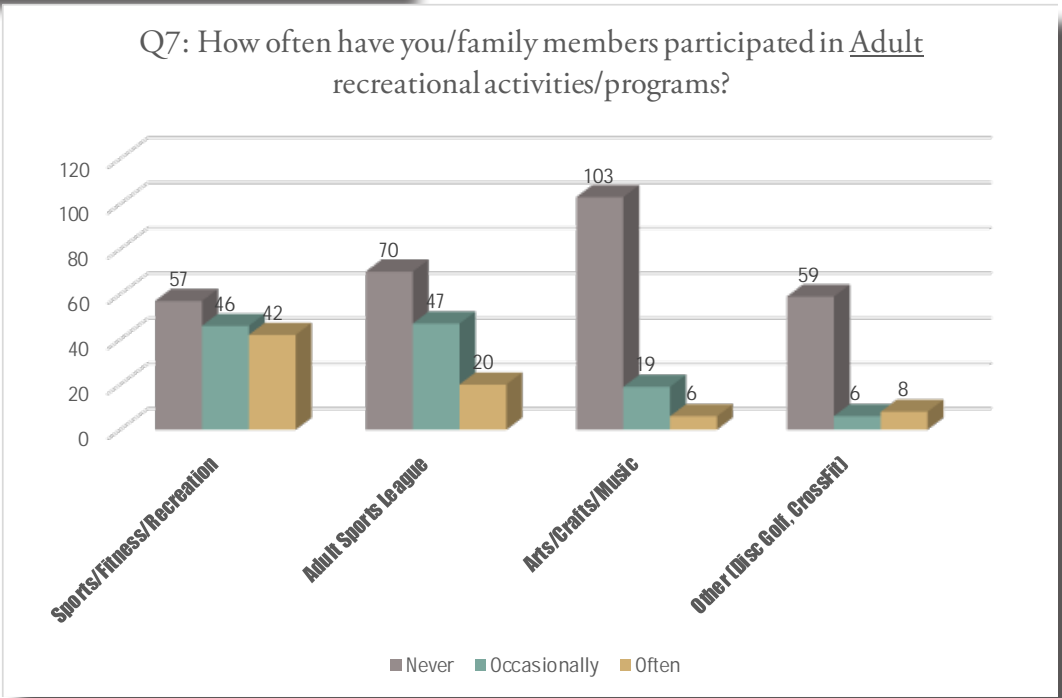
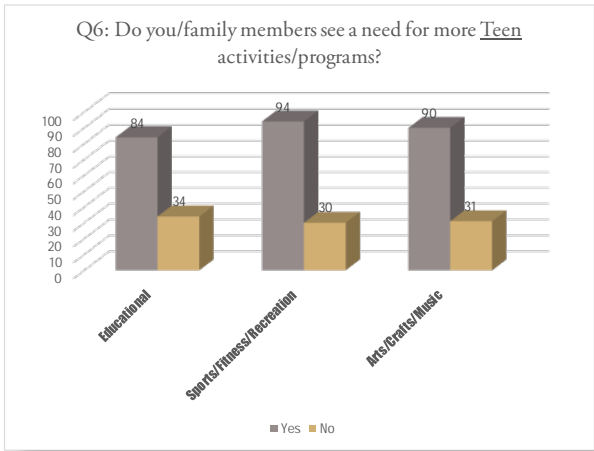

Q11: Indicate how likely you would be to enroll your child(ren) in an after-school program offered through the Parks & Rec Department.

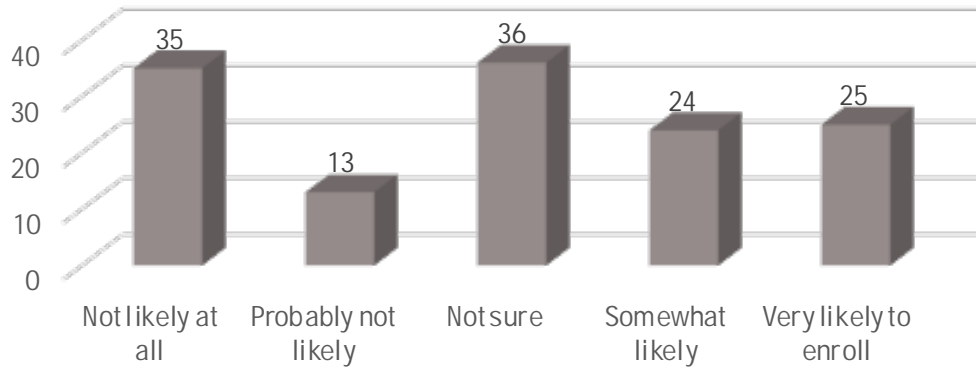

Q13: Do you/family members see a need to develop more of these facilities at area park sites?

